

A1

Installation guide for ARENA



Installation kit A1 contains 0,5 m chain, 2 spring hooks and 1 eye coupling nut

Before mounting - make sure delivered kits equals your order.

Installation guide

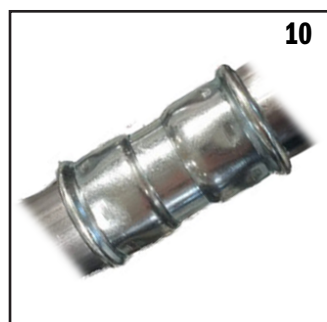
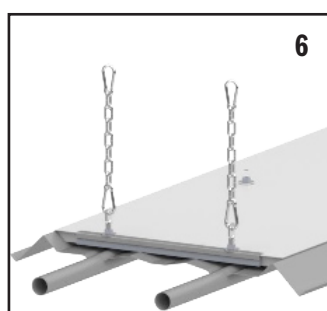
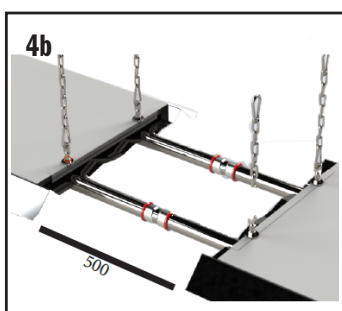
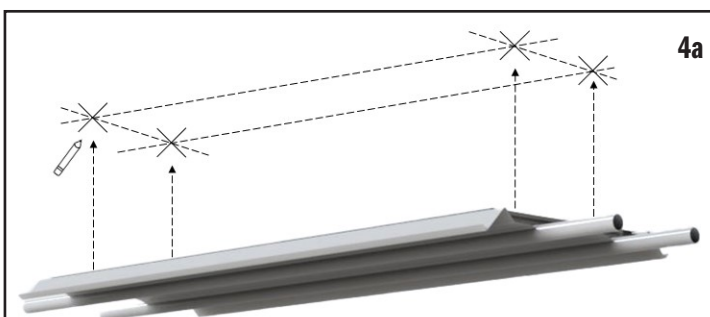
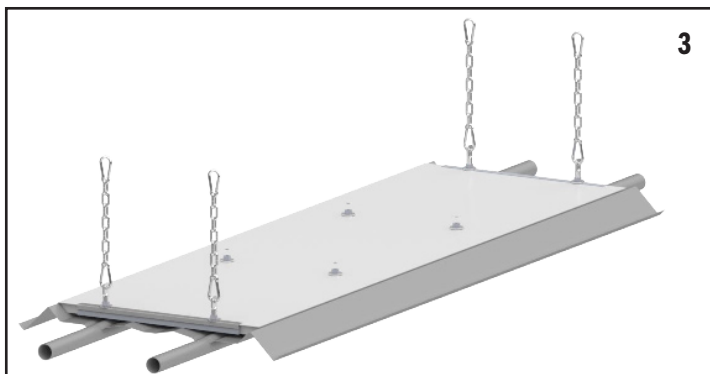
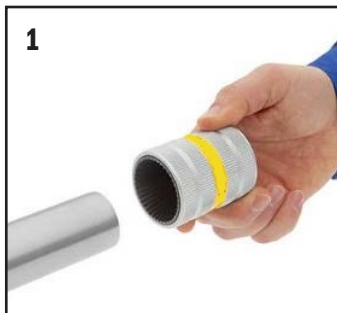

1. Carefully grade all pipes both internally and externally. Fillings may damage the O-ring of the press coupling and make it leaky.

2. Measure the insert depth of the press fitting and mark it on the pipes.

3. Fasten eye coupling nuts to bolts in the four corners of the panel.

NOTE! Panels longer than 3 meters must be provided with additional two anchor points placed in the middle of the panel.

4a. Measure the distance (length and width) between the anchor points and mark these in the ceiling.

4b. Distance between anchor points in opposite corners of two panels mounted close together are about 500 mm. Add this measure when marking for the next panel in the row.

5. Install the appropriate mounting bracket in the roof structure. The tensile strength of each bracket should not be less than 40 kg. *Brackets are not included in the installation kit.*

Cut the chain to desired lengths and attach it to the eye coupling nut using the supplied spring hooks.

Mount the panels to the ceiling brackets.

Insert press fittings to the markings on pipes (see fig. 2).

Check that the correct tool is used when pressing. Read the tool usermanual to make sure that all pressing is performed as instructed. *Factory-fitted press fittings are of the "M" type.*

. The pressure indicator comes off easily and is removed after completion pressing.

11. Check that the panels hangs at the desired height and slope for efficient deaeration. Adjust chain if necessary.

12. Consider the pipes length expansion when installing several panels in serial. If needed compensate according to normal procedure with expansion bend or flexible metal hose.

Important after installation!

After installation, a leak check must be performed in the system. The system should be inspected under a pressure that is 1.3 times higher than the maximum working pressure. The system is ok if pressure drops do not occur within three hours.

When testing is performed, check that all safety and vent valves work properly.

Maximum pressure ARENA: 10 bar

Test pressure ARENA: 13 bar