



BRIZA 22 HYBRID

EN

Service manual: Wall and Ceiling model - Europe



*Plafondmodel / Modèle de plafond
Deckenmodell / Ceiling model*



*Muurmodel / Modèle de mur
Wandmodell / Wall model*

CONTENT

GENERAL DESCRIPTION	42
WARNINGS AND SAFETY	42
USED SYMBOLS.....	43
SPARE PARTS	44
JAGA BRIZA 22.....	45
MAINTENANCE.....	46
FILTER REPLACEMENT	47
FAN UNIT REPLACEMENT	48
THE HEAT EXCHANGER REPLACEMENT	49
GUARANTEE	50

DECLARATION OF CONFORMITY

CEO JAGA N.V.
Jan Kriekels



26/03/2018

JAGA N.V. - Verbindingslaan 16 - B 3590, declares under its sole responsibility that the product to which this declaration relates: **BRIZA 12, BRIZA 22** is in conformity with the following standards or documents provided that these are used in accordance with our instructions: **NBN EN 60335-1 based on EN 60335-1:2012 + A11:2014**
NBN EN 60335-2-80 based on EN 60335-2-80:2003 + A 1 :2004 + A2:2009

Following the provision of Directives as amended:

- Low Voltage 2014/35/EC
- EMC 2014/30/EC
- Machinery 2006/42/EC



Jaga N.V.
Verbindingslaan 16
B-3590 Diepenbeek
info@jaga.be / www.jaga.be

 **+32 (0)11 29 41 11**



IMPORTANT INFO

Read this manual carefully to ensure the device will be installed properly. Fully complying with the contents of this manual is the only way to ensure that failures are prevented and the device will work correctly. Failure to follow the safety instructions, assembly conditions, instructions, warnings and notes in this document could result in bodily injury or damage to the unit.

Please keep these instruction.

The guarantee will be void when:

- malfunctions or damage occur due to non-compliance with the installation, cleaning, or usage instructions provided by the manufacturer.
- the device is used or handled in an incorrect, improper, and/or irresponsible manner
- incorrect or non-professional repairs and defects arise due to external factors
- any repair carried out by yourself
- devices are installed in a manner that makes the devices difficult to access

This device is covered by the general warranty conditions of Jaga NV

Jaga reserves the right to change product specification at any time in line with our policy of continuous improvement and innovation.

GENERAL DESCRIPTION

Identification of the unit:

The units are equipped with a label sharing the serial number plate on the right side of the unit (on the left if the connections are on the right side of the unit).

Operational limits:

An installation that does not meet the specified operational limits releases Jaga NV from all liability with respect to damage to objects or people.

- mains voltage: 230 V \sim - 1 ph - 50 Hz
- maximum water inlet temperature: 90°C
- maximum pressure heat exchanger: 10 bar
- supply voltage: 230 V \sim \pm 10 %.

Putting out of operation:

If the device will not be in use for a long period, the user should turn off the power supply by switching the power switch to the OFF position.

If the unit is not used during the winter period, the water contained in the system may freeze. All the water in the circuit must be drained on time. If draining the system is too complex, a suitable amount of antifreeze liquid can be mixed with the water.

Anti-freeze protection:

Mixing the water with glycol modifies the performance of the unit. Pay attention to the safety instructions on the package regarding glycol.

Restart after prolonged shutdown:

- clean or replace the air filter.
- clean the exchanger.
- clean or unclog the drain of the condensate tray.
- bleed the water system.
- it is advisable to run the unit at maximum speed for several hours.

WARNINGS AND SAFETY

General:

- the unit must be installed and connected by an approved installer in accordance with these installation instructions and the applicable national and local regulations.
- the customer must engage qualified staff, all applicable construction and safety regulations must be complied with during installation, commissioning, and maintenance of this product..
- during installation and maintenance, always wear suitable personal safety equipment, such as safety shoes, safety goggles, etc.
- the unit has sharp edges; always use gloves
- always switch off and unplug the power supply before installation or maintenance
- do not insert body parts or objects in the air inlet or outlet
- pay the utmost attention to the signs and symbols located on the appliance

Packaging:

- PROTECT THE ENVIRONMENT: remove the packaging materials and dispose them at the proper collection points or recycling facilities in accordance with the local regulations
- keep the packaging out of the reach of children

Connection:

- Non-conforming electrical and hydraulic connections releases Jaga N.V. from liability concerning damage to objects and persons.

Use:

- this device is not intended to be used by people (including children) with reduced physical, sensory, or mental capacities, or who lack experience or knowledge, unless a person responsible for their safety supervises them or has explained how the device must be operated
- always supervise children to ensure that they do not play with the device. Please read the user manual carefully

Maintenance:

- maintaining the device is very important to ensure it works correctly. Maintenance must be performed on a regular basis depending on the use and function of the room where the device is installed
- engage only qualified people to perform the maintenance work
- only use original replacement parts
- cover: clean with a soft moist cloth
- cover: do not use products based on solvents or cleaning agents

Dismantle the device:

Jaga N.V. always focuses a lot of attention on protecting the environment.

If the device is dismantled, it is important to observe the following procedures:

- the device may only be dismantled by a company that is qualified to remove the waste from machines/products

The device as a whole is composed of material considered to be secondary raw materials and the following condition must be complied with:

- a device that contains antifreeze must be dismantled in an environmentally conscious manner and must not be handled as ordinary waste.
- the electronic components (electrolytic capacitors) are considered as special waste and must be removed and transported by an organisation that is authorised to collect such waste.
- the tubing insulation is made from polyurethane foam. Polyurethane foam mesh and sound-insulating coating foam must be removed and treated like municipal waste

USED SYMBOLS

danger



danger: electrical hazard



danger: hot surfaces



danger: moving parts



danger: sharp edges / components



attention: important warning



environmental safeguard



vdc - direct current



vac - alternating current

SPARE PARTS

Note: for replacement or defective parts, contact the installer and consult the general JAGA warranty terms (see page 50).

BRIZA 22:	02	03	04	06	08
-----------	----	----	----	----	----

FILTER

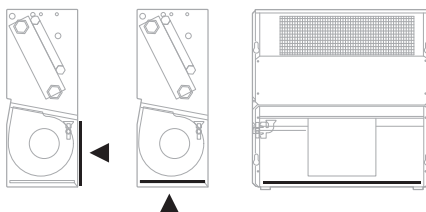

Code	8721.401	8721.402	8731.403	8731.404	8731.405
------	----------	----------	----------	----------	----------

STANDARD HEAT EXCHANGER

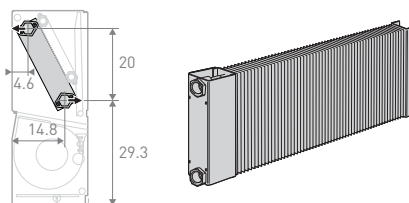

Code	8776.0301	8776.0302	8776.0303	8776.0304	8776.0305
------	-----------	-----------	-----------	-----------	-----------

OPTION: ADDITIONAL HEAT EXCHANGER (4-PIPE)

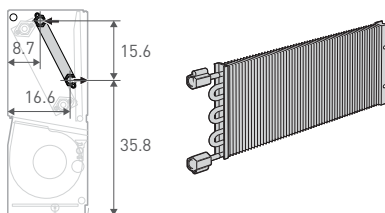

Code	8721.5401	8721.5402	8721.5403	8721.5404	8721.5405
------	-----------	-----------	-----------	-----------	-----------

FAN

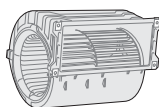

24560.02200010

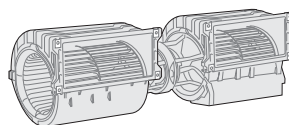

24560.02200011

24560.02200010	1x			1x	
24560.02200011		1x	1x	1x	2x

JAGA BRIZA 22

WALL - OVERVIEW PARTS

Dynamic Low-H₂O hydrophilic heat exchanger

Hydraulic connection
(2-pipe 3/4" G)

Hydraulic connection
(4-pipe 1/2" G)

Condensate drain
(Ø 20mm)

Replacable filter

Frame made of reinforced galvanised steel plate



EN

Electrical connection

Centrifugal fan(s) with double inlet

CEILING - OVERVIEW PARTS

Dynamic Low-H₂O hydrophilic heat exchanger

Hydraulic connection

Condensate drain
(Ø 20mm)

Frame made of reinforced galvanised steel plate

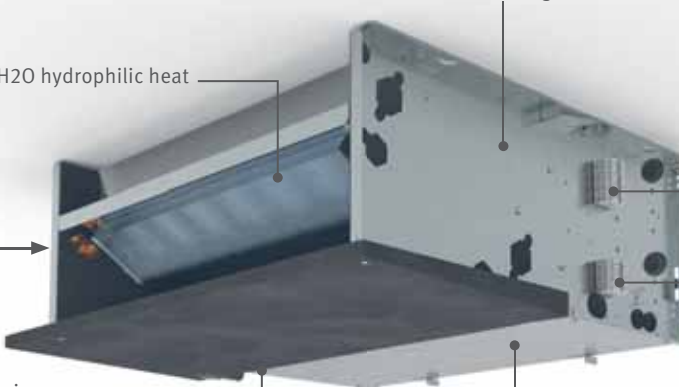

Filter

Electrical connection

Inside :Centrifugal fan(s) with double inlet

MAINTENANCE

Routine maintenance

Monthly: Checking the air filters.

The air filters are made of fibre, which can be washed with water. The level of pollution of the filters must be checked at the beginning of the season when the unit will be used and generally every month. Only an authorized installer may replace the filter.

Every 6 months: Check the condition of the exchanger and condensate drain.

If necessary:

- remove any debris from the finned surface to clear the air passage
- remove the dust using compressed air
- gently wash with water and brush gently
- dry using compressed air
- keep the condensate drain free from any obstructions that may prevent normal water flow

Checking whether there is air in the water system.

1. start the system for a few minutes.
2. stop the system.
3. loosen the vent screw on the inlet collector and bleed it.
4. repeat the operation several times until air is no longer released for the system.

End of season: Draining the water system (for all exchangers)

It is advisable to drain the water from the system at the end of the season in order to prevent breakage due to freezing.

Electrical circuit

The following operations are recommended to perform maintenance on the electrical circuit:

- check the unit power consumption using a clip-on meter and compare the reading with the values shown in the documentation;
- inspect and check that the electrical contacts and relative terminals are tightened correctly.

FILTER REPLACEMENT

Reference: see page 44

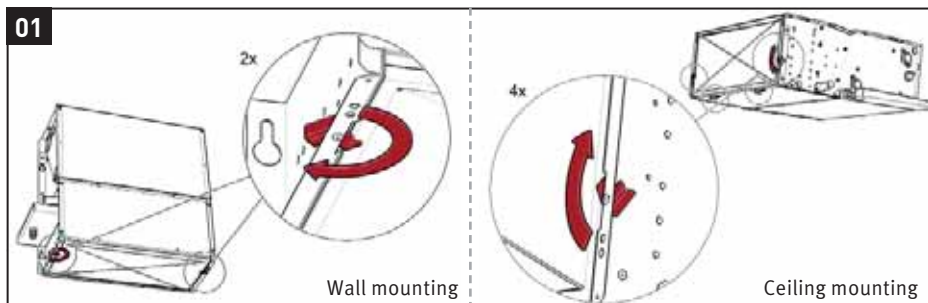

Turn locks, at the side of the unit, open.

For ceiling units: there are 2 extra locks at the front of the unit.

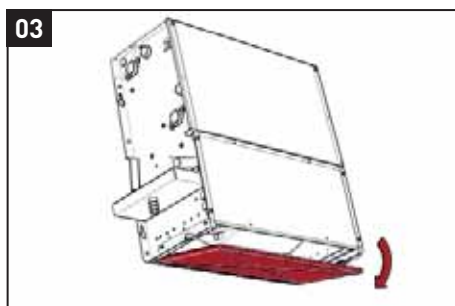

Take the filter out of the unit.



Place a the new filter in the unit.

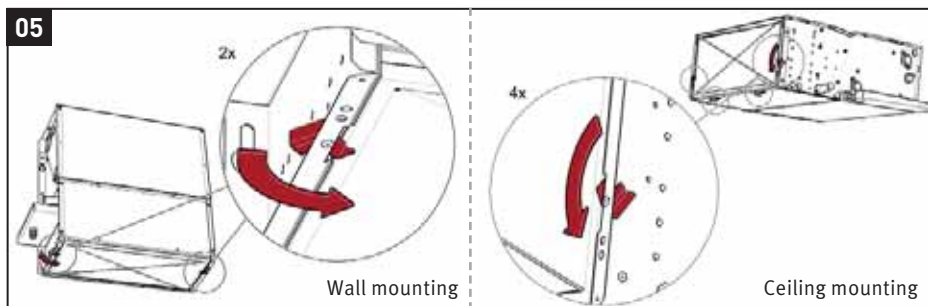

Relock the filter by turning the 2 or 4 locks.

FAN UNIT REPLACEMENT

Reference: see page 44

If the electric motor of the fan malfunctions, the entire fan unit must be replaced.

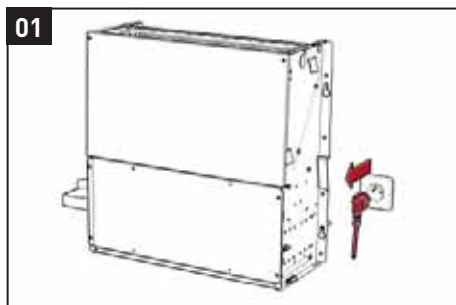

Ensure electrical power is completely disconnected.

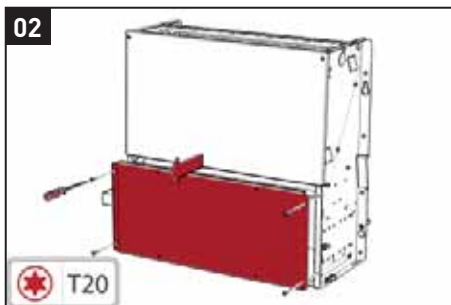

Remove 4 screws from the lower frontpanel. And remove the panel.

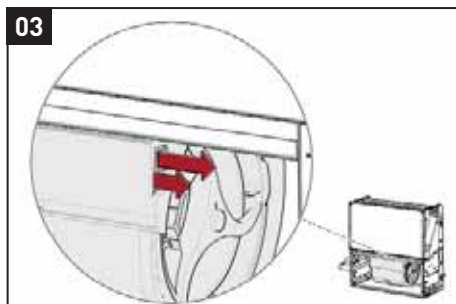

Disconnect the electrical fan connection cable.

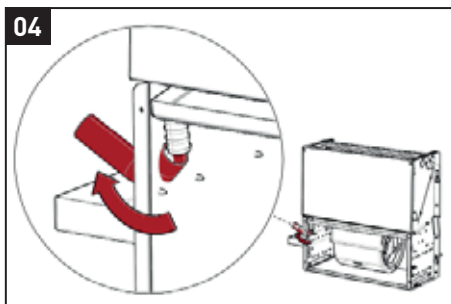

Remove the small rubber pipe of the condensate drain.

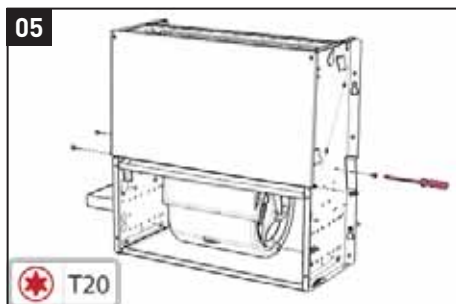

Remove the 4 screws that secure the fan to the unit.

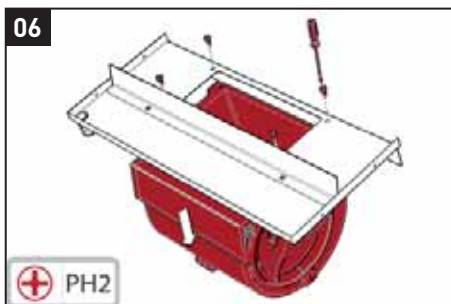

Remove the fan unit from the plate by loosening 4 screws.

07 Follow the instructions in the reverse order to re-mount the fan unit.

THE HEAT EXCHANGER REPLACEMENT

Reference: see page 44

EN

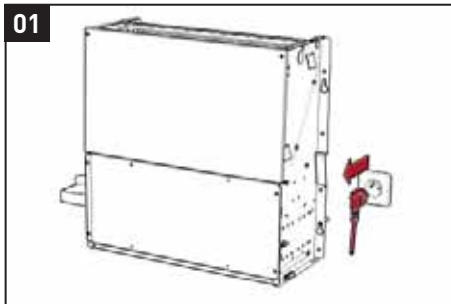

01 Ensure electrical power is completely disconnected.

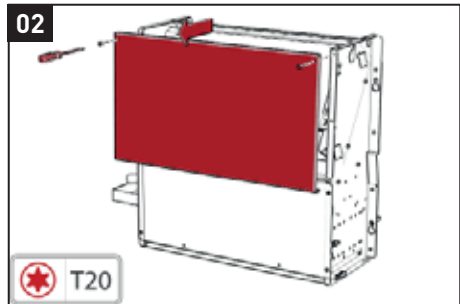

02 Remove 2 screws from the upper frontpanel. And remove the panel.

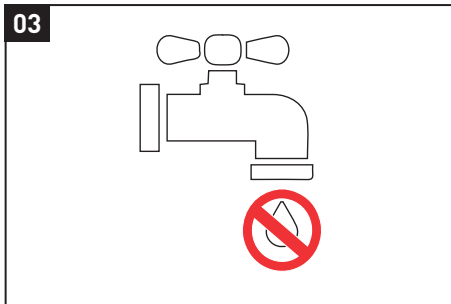

03 Turn off the water supply and return.

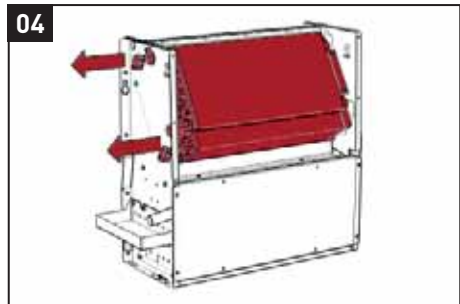

04 Disconnect the coil from the system.

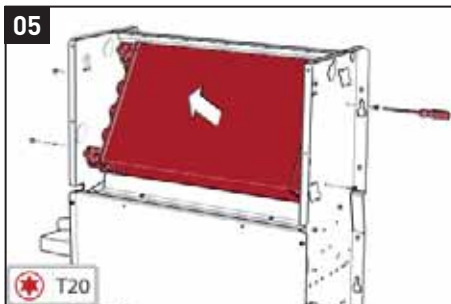

05 2-pipe: Remove the screws on both sides that secure the heat exchanger and remove the heat exchanger.

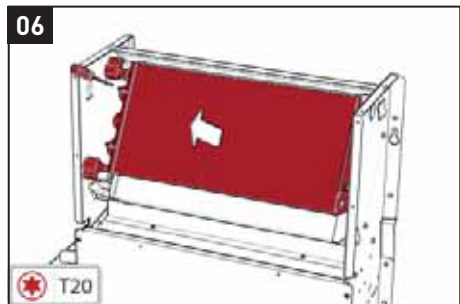

06 4-pipe: Remove the 4 screws that secure the smallest heat exchanger and remove the heat exchanger.

07 Follow the instructions in the reverse order to re-mount the heat exchanger unit.

GUARANTEE

- 5 years** heat-exchanger
- 2 years** electrical parts
- 10 years** all other components

1. The guarantee is valid only if the equipment is properly and correctly used, by its first owner and if installed in accordance with the norms and instructions as stipulated in the instruction leaflet and the current practices.
2. The guarantee only applies to the equipment and the spare parts. Jaga has the choice between repair and replacement of the equipment or the spare parts. If there has been a change in the model, Jaga is authorised to replace the guaranteed equipment with an equivalent equipment or equivalent spare parts. In those cases where the guarantee claim is accepted, during the first six months after the start of the guarantee, Jaga gives an extra guarantee on agreed replacement and transport costs.
3. The period of guarantee is mentioned in this certificate. A repair or replacement does not change anything to the original period of guarantee.
4. No guarantee is granted on equipment or spare parts lacking information concerning type or series, or on equipment where this information has been removed or altered, or on equipment that has been repaired or modified by persons not authorized by Jaga.
5. The customer is responsible for the damage in the cases where the damage is due to errors of placement, fittings, electrical connections, faulty or damaged electrical installations or appliances, erroneous voltage or hydraulic pressure and all other errors not related to the product delivered by Jaga. The guarantee is also revoked when nonsuited parts are applied. The guarantee for our heat exchangers is not valid if they are emptied at set times or during a certain period, or if they are heated by means of industrial water, steam or water saturated by great quantities of oxygen. The quality of the system water has to be in accordance with the VDI 2035-2 directives. The guarantee is also revoked when the heat exchangers are placed in aggressive atmospherical surroundings (ammonia, caustic substances). Lacquered radiators should not be used in the following areas: above a bath with a built-in shower unit, in a shower cubical or next to it, in a swimming pool (chlorine) or in a sauna
6. Jaga does not give a guarantee on faulty equipment due to incorrect handling and/or use of the equipment, the dropping of the equipment or the transport without the necessary precautions, or for all equipment that is built in, in a way that it cannot be reached normally.
7. In all cases where the guarantee is granted but where the intervention occurs later than 6 months after the start of the guarantee, and in all other cases, labour and transportation costs are calculated according to scales set by Jaga. Customers can get information on those scales either from our sales administration personnel, or from the maintenance engineer.
8. All interventions not covered by the guarantee have to be paid in cash to the maintenance engineer.
9. The guarantee starts on the date of the invoice. If the invoice is not available, the serial number or the date of production prevails.
10. Only the courts of judicial district Hasselt (Belgium) are authorised to deal with disputes arising from this guarantee. It will apply Belgian law even when sales involved are subjects of EU member states as well as non-EU member countries.



Jaga N.V., Verbindingslaan 16, B-3590 Diepenbeek
Tel.: +32 (0)11 29 41 11, Fax: +32 (0)11 32 35 78
jaga info@jaga.be, www.jaga.be

April 17, 2018 9:36 AM - Jaga N.V.